

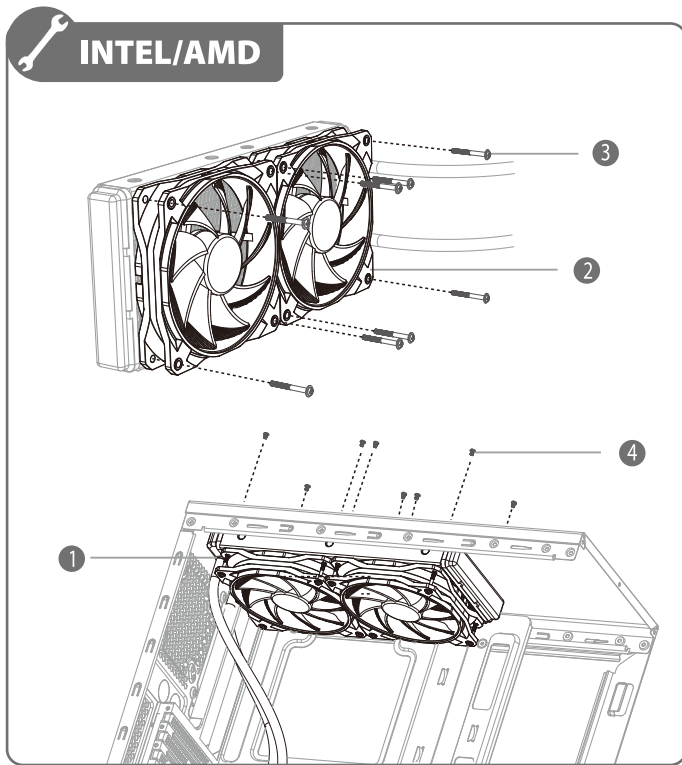

# MAELSTROM 240

User manual

1 Heatsink set	1 pc	2 120mm Fan	2 pcs	3 Screw(1)	8 pcs	4 Screw(2)	8 pcs	5 Back Plate	1 pc	6 Screw Bolt	4 pcs
7 Insulative cushion	4 pcs	8 Screw(3)	4 pcs	9 Mounting Bracket(intel)	2 pcs	10 Mounting Bracket(AMD)	2 pcs	11 Double-screw Bolt (For LGA2011 only)	4 pcs	12 Nut	4 pcs
13 Fan Hub(Cable length 420mm)	1 pc	14 3M Sticker	1 pc	15 Cable Tie	1 pc	16 Extension cable	1 pc	Well note: Please keep cooling block at the direction which has no interference with the neighboring parts.			



INTEL

LGA1366  
LGA1156  
LGA1155  
LGA1150

Installation

AMD

FM2+  
FM2  
FM1  
AM3+  
AM3  
AM2+  
AM2

Installation

INTEL

LGA2011

LGA2011-v3

Installation

INTEL/AMD

