

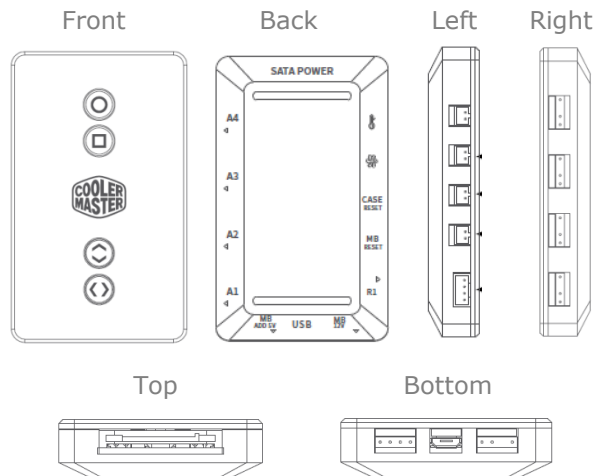

USER MANUAL

01. Controller Description



02. Left Side Functions

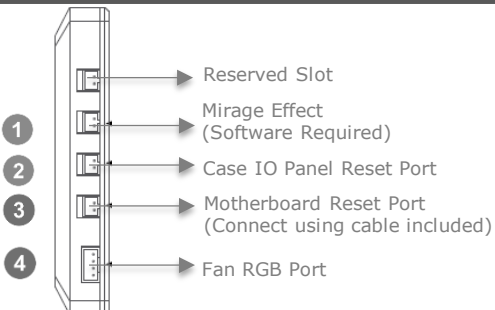

When ② & ③ Plugged in:
The Reset Button on the Case IO Panel can be used to switch between LED modes. Press and Hold for 5 secs to restart your computer

03. Bottom Functions

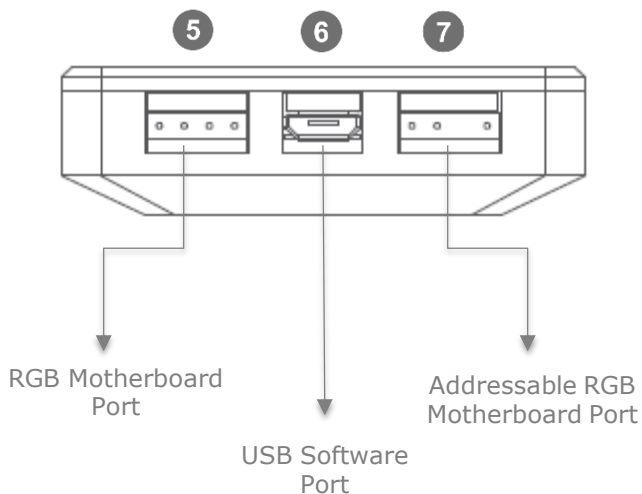

04. Right Side Function

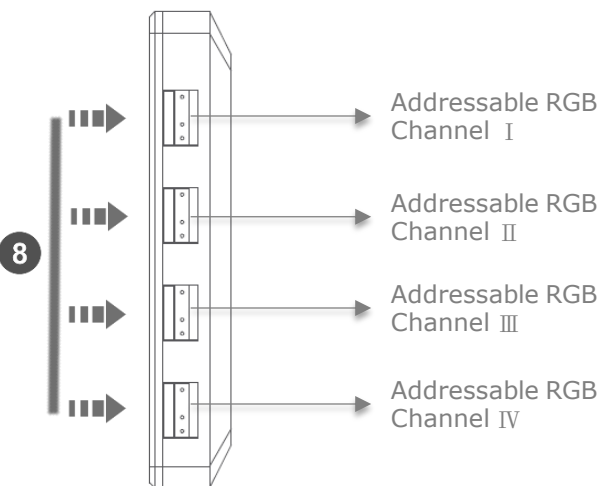

05. Top Function

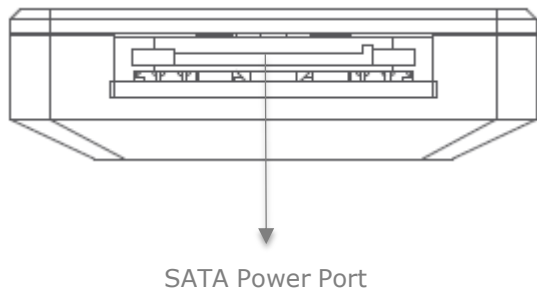

06. Wire Instruction (At Your Choice)

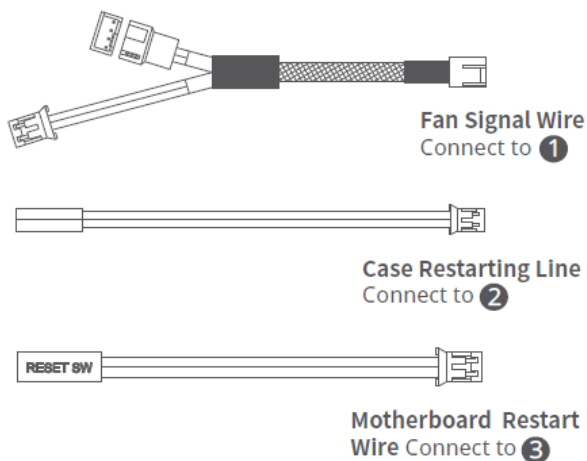



USER MANUAL

07. Wire Instruction (At Your Choice)



RGB 4-Pin Connector
Connect to **4**



RGB 4-Pin Motherboard Connector
Connect to **5**



USB Header Connector
Connect to the motherboard USB port

08. Wire Instruction (At Your Choice)



USB Adapter
Connect to **6**

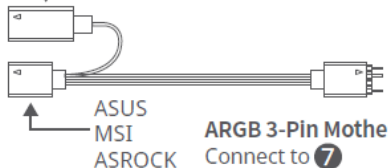

ARGB 3-Pin Motherboard Connector
Connect to **7**

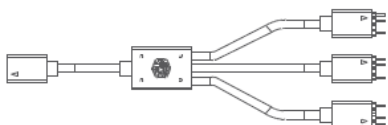

One to Three ARGB Connector
Connect to **8**

09. Basic Installation Diagram

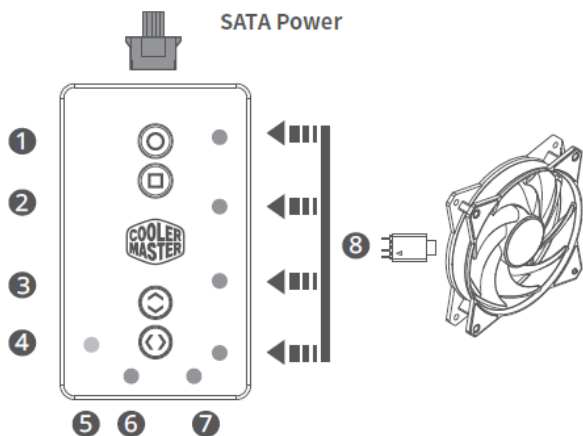

Note:
This basic connection method can control the ARGB light.

10. Key Function Description

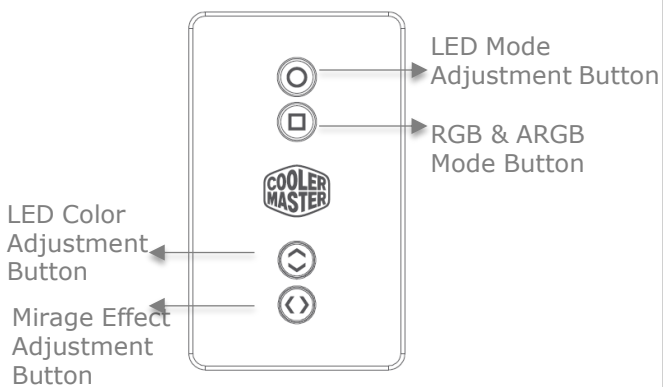

11. Addressable RGB/RGB Mode

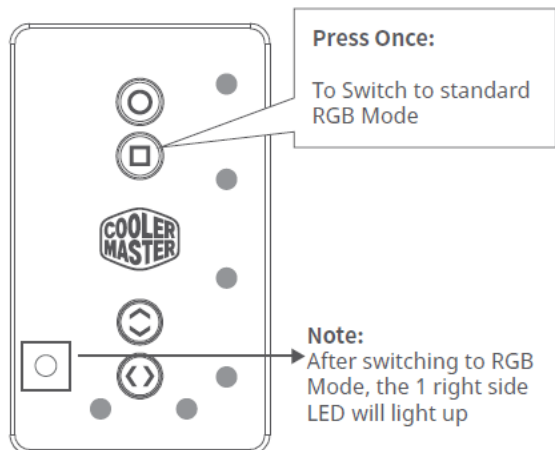

12. Addressable RGB/RGB Mode

